

2

1

**PROPRIETARY AND CONFIDENTIAL**

THE INFORMATION CONTAINED IN THIS DRAWING IS THE SOLE PROPERTY OF PRESSURELINKS. ANY REPRODUCTION IN PART OR AS A WHOLE WITHOUT THE WRITTEN PERMISSION FROM PRESSURELINKS IS PROHIBITED.

B

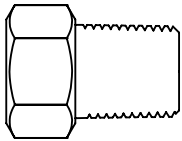

DESCRIPTION	PL PART #	HEX Ø	OAL	WEIGHT (LBS)
1/16 NPT HEX PLUG	1NP15	0.375	0.63	.02
1/8 NPT HEX PLUG	2NP15	0.500	0.75	.03
1/4 NPT HEX PLUG	4NP15	0.625	0.90	.07
3/8 NPT HEX PLUG	6NP15	0.750	0.98	.11
1/2 NPT HEX PLUG	8NP15	0.875	1.13	.18
3/4 NPT HEX PLUG	12NP10	1.125	1.35	.36
1 NPT HEX PLUG	16NP10	1.375	1.64	.67

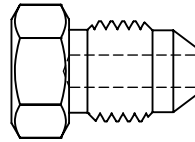
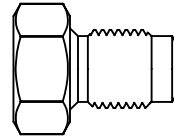

DESCRIPTION	PL PART #	HEX Ø	OAL	WEIGHT (LBS)
1/4 BSP EXTERNAL PLUG	4BEXTP30	0.750	1.09	.09

DESCRIPTION	PL PART #	HEX Ø	OAL	WEIGHT (LBS)
1/4 JIC HEX PLUG	4JP15	0.500	0.81	.03
3/8 JIC HEX PLUG	6JP15	0.625	0.85	.05
1/2 JIC HEX PLUG	8JP15	0.750	1.04	.10
5/8 JIC HEX PLUG	10JP10	0.875	1.11	.14
3/4 JIC HEX PLUG	12JP10	1.125	1.29	.26
1 JIC HEX PLUG	16JP10	1.375	1.34	.38

B

A

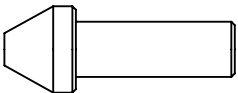

DESCRIPTION	PL PART #	OD Ø	OAL	WEIGHT (LBS)
1/4 MP PLUG	4MP20	0.375	1.00	.02
3/8 MP PLUG	6MP20	0.480	1.26	.04
9/16 MP PLUG	9MP20	0.725	1.56	.12
3/4 MP PLUG	12MP20	0.940	1.75	.25
1 MP PLUG	16MP20	1.250	2.38	.58

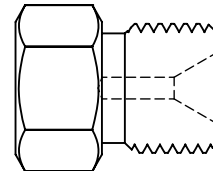

DESCRIPTION	PL PART #	HEX Ø	OAL	WEIGHT (LBS)
9/16 TYPE M HEX PLUG	9TMP40	0.625	0.88	.06
3/4 TYPE M HEX PLUG	12TMP30	0.750	1.00	.10
7/8 TYPE M HEX PLUG	14TMP40	0.875	1.13	.18
1 TYPE M HEX PLUG	16TMP30	1.000	1.13	.22
1-1/8 TYPE M HEX PLUG	18TMP40	1.125	1.44	.39
1-5/16 TYPE M HEX PLUG	21TMP20	1.375	1.25	.43

A

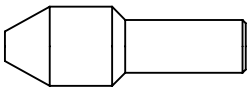

DESCRIPTION	PL PART #	OD Ø	OAL	WEIGHT (LBS)
1/4 HP PLUG	4HP60	0.375	1.14	.02
3/8 HP PLUG	6HP60	0.500	1.32	.05
9/16 HP PLUG	9HP60	0.812	1.75	.16

**PressureLinks**  
High Performance Fittings

TITLE: **800 PLUGS  
MASTER LIBRARY**

SIZE <b>A</b>	DWG. NO. <b>PLUGS</b>	REV <b>A</b>
SCALE: 1:1		SHEET 1 OF 1

2

1