

PROPRIETARY AND CONFIDENTIAL

THE INFORMATION CONTAINED IN THIS DRAWING IS THE SOLE PROPERTY OF PRESSURELINKS. ANY REPRODUCTION IN PART OR AS A WHOLE WITHOUT THE WRITTEN PERMISSION FROM PRESSURLINKS IS PROHIBITED.

B

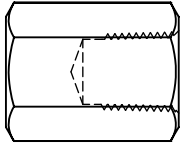

DESCRIPTION	PL PART #	HEX ϕ	OAL	WEIGHT (LBS)
1/8 NPT CAP	2NCAP15	0.625	0.90	.07
1/4 NPT CAP	4NCAP15	0.750	1.16	.12
3/8 NPT CAP	6NCAP15	0.875	1.25	.18
1/2 NPT CAP	8NCAP15	1.125	1.43	.33
3/4 NPT CAP	12NCAP10	1.375	1.50	.50
1 NPT CAP	16NCAP10	1.750	1.88	1.04

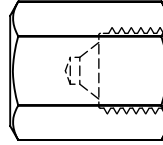

DESCRIPTION	PL PART #	HEX ϕ	OAL	WEIGHT (LBS)
1/4 JIC CAP	4JCAP15	0.625	0.83	.07
3/8 JIC CAP	6JCAP15	0.750	0.93	.10
1/2 JIC CAP	8JCAP15	0.875	1.04	.14
5/8 JIC CAP	10JCAP10	1.000	1.16	.19
3/4 JIC CAP	12JCAP10	1.250	1.31	.35
1 JIC CAP	16JCAP10	1.500	1.50	.56

B

A

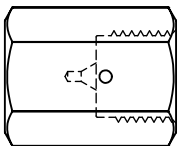

DESCRIPTION	PL PART #	HEX ϕ	OAL	WEIGHT(LBS)
1/4 HP CAP	4HCAP60	0.750	1.07	.12
3/8 HP CAP	6HCAP60	1.000	1.26	.24
9/16 HP CAP	9HCAP60	1.375	1.50	.49

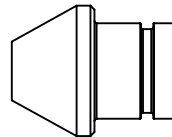

DESCRIPTION	PL PART #	OD ϕ	OAL	WEIGHT (LBS)
9/16 TYPE M PLUG FOR CAP	9TMCAP40	0.485	0.62	.02
3/4 TYPE M PLUG FOR CAP	12TMCAP30	0.675	0.75	.05
1 TYPE M PLUG FOR CAP	16TMCAP30	0.868	0.90	.10
1-5/16 TYPE M PLUG FOR CAP	21TMCAP20	1.215	1.19	.28

A

PressureLinks
High Performance Fittings

TITLE: **700 CAPS
MASTER LIBRARY**

SIZE A	DWG. NO. CAPS	REV A
SCALE: 1:1		SHEET 1 OF 1