

2

1

PROPRIETARY AND CONFIDENTIAL

THE INFORMATION CONTAINED IN THIS DRAWING IS THE SOLE PROPERTY OF PRESSURELINKS. ANY REPRODUCTION IN PART OR AS A WHOLE WITHOUT THE WRITTEN PERMISSION FROM PRESSURLINKS IS PROHIBITED.

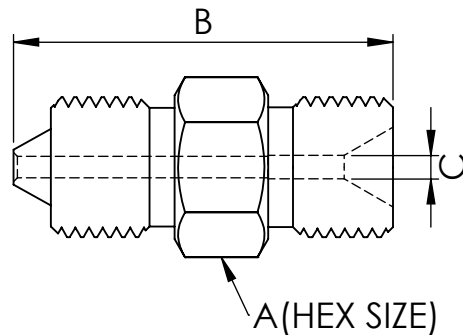

DESCRIPTION	PL PART #	(A) HEX	(B) OAL	(C) THRU ϕ	WEIGHT(LBS)
1/4 HP X 9/16 TYPE M	4H09TM40	0.625	1.52	0.086	.09
1/4 HP X 3/4 TYPE M	4H12TM30	0.750	1.65	0.086	.13
3/8 HP X 9/16 TYPE M	6H09TM40	0.750	1.75	0.093	.15
3/8 HP X 3/4 TYPE M	6H12TM30	0.750	1.88	0.120	.18
3/8 HP X 7/8 TYPE M	6H14TM40	0.875	2.00	0.120	.25
9/16 HP X 9/16 TYPE M	9H09TM40	1.125	2.00	0.093	.38
9/16 HP X 3/4 TYPE M	9H12TM30	1.125	2.13	0.182	.40
9/16 HP X 7/8 TYPE M	9H14TM40	1.125	2.25	0.150	.46
9/16 HP X 1 TYPE M	9H16TM30	1.125	2.13	0.182	.45
9/16 HP X 1-1/8 TYPE M	9H18TM40	1.125	2.44	0.182	.58
9/16 HP X 1-5/16 TYPE M	9H21TM20	1.375	2.25	0.182	.63
1 HP X 3/4 TYPE M	16H12TM30	1.125	3.68	0.312	.64
1 HP X 1 TYPE M	16H16TM30	1.125	3.68	0.390	.67

PressureLinks
High Performance Fittings

TITLE:

**305 HP MALE X TYPE M MALE
MASTER LIBRARY**

SIZE

A

DWG. NO.

HP MALE X TYPE M MALE

REV

A

SCALE: 1:1

SHEET 1 OF 1

2

1