

2

1

PROPRIETARY AND CONFIDENTIAL

THE INFORMATION CONTAINED IN THIS DRAWING IS THE SOLE PROPERTY OF PRESSURELINKS. ANY REPRODUCTION IN PART OR AS A WHOLE WITHOUT THE WRITTEN PERMISSION FROM PRESSURLINKS IS PROHIBITED.

B

B

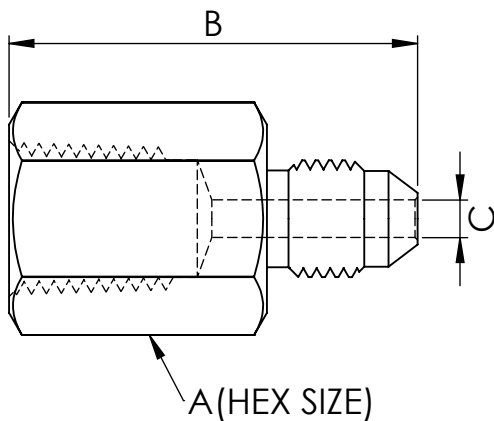

DESCRIPTION	PL PART #	(A) HEX	(B) OAL	(C) THRU ϕ	WEIGHT(LBS)
1/4 NPT FEM X 1/4 JIC	4NF04J15	0.750	1.52	0.140	.11
1/4 NPT FEM X 3/8 JIC	4NF06J15	0.750	1.51	0.203	.12
1/4 NPT FEM X 1/2 JIC	4NF08J15	0.750	1.59	0.312	.14
3/8 NPT FEM X 1/4 JIC	6NF04J15	0.875	1.54	0.140	.14
3/8 NPT FEM X 3/8 JIC	6NF06J15	0.875	1.53	0.203	.14
3/8 NPT FEM X 1/2 JIC	6NF08J15	0.875	1.61	0.312	.16
1/2 NPT FEM X 1/4 JIC	8NF04J15	1.125	1.77	0.140	.27
1/2 NPT FEM X 3/8 JIC	8NF06J15	1.125	1.76	0.203	.27
1/2 NPT FEM X 1/2 JIC	8NF08J15	1.125	1.84	0.312	.29
1/2 NPT FEM X 3/4 JIC	8NF12J10	1.125	2.01	0.500	.35
3/4 NPT FEM X 1/2 JIC	12NF08J10	1.375	1.87	0.312	.41
3/4 NPT FEM X 3/4 JIC	12NF12J10	1.375	2.05	0.500	.47
1 NPT FEM X 1 JIC	16NF16J10	1.750	2.30	0.750	.82

A

A

PressureLinks
High Performance Fittings

TITLE:
**114 NPT FEMALE X JIC MALE
MASTER LIBRARY**

SIZE A	DWG. NO. NPT FEMALE X JIC MALE	REV A
------------------	--	-----------------

SCALE: 1:1	SHEET 1 OF 1
------------	--------------

2

1